

# Universal Pan Racks

Sturdy aluminum racks suitable for storage and transportation of steam table pans, meat trays, or bun pans. This rack accepts 12" meat trays, 18" x 26" pans or trays, standard steam table pans and several sizes of oval trays.



#### FEATURES:

- Constructed from heavy duty square aluminum tube
- Heavy duty 4" aluminum runners
- Fully assembled and ready to use

#### REPLACEMENT PARTS:

- (4) Swivel 5" x 1.25" polyurethane wheels. Replacement Order #B000312





Freight Class: 300  
 NMFC Code: 164390-S2

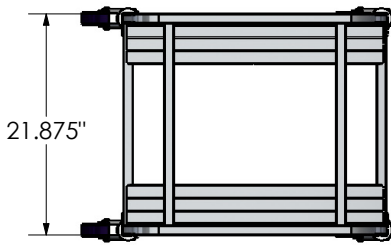

8040704

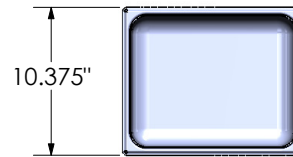

B001140

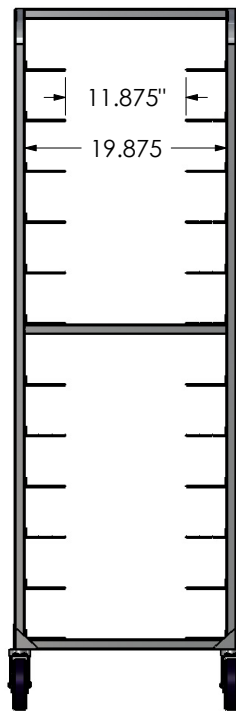
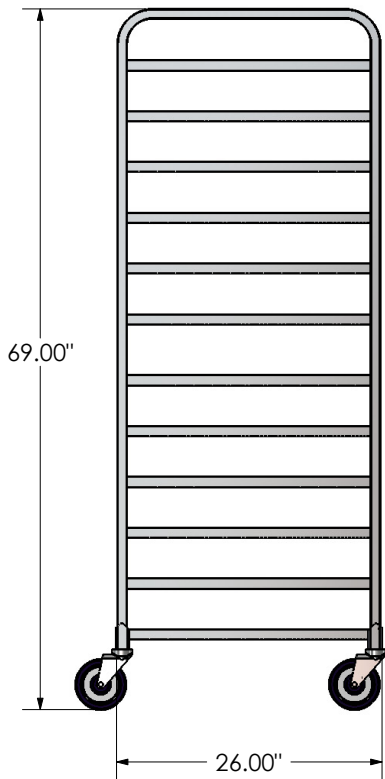
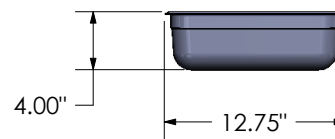

B001139

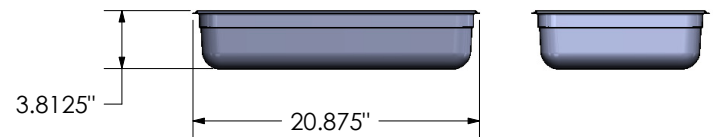

Order #	Model	W	L	H	Shelf Spacing	# of Shelves	Weight
8040704	AL-UPC-12-FS	21 7/8"	26"	69"	5"	12	52 lbs.
8040705	AL-UPC-20-FS	21 7/8"	26"	69"	3"	20	70 lbs.
B001140	Steam Pan 1210	10 3/8"	12 3/4"	4"	NA	NA	2 lbs.
B001139	Steam Pan 1220	12 3/4"	20 7/8"	3 7/8"	NA	NA	4 lbs.

Can't find exactly what you need? Give us a call and we'll help you with the perfect solution!